

# Hoffman

CALIFORNIA-INTERNATIONAL FABRICS

"Bears and Paws" designed by Kari Nichols 55" x 52"



Above pattern uses Hoffman "Call of the Wild" digital fabric P4356 44-Forest (1 panel) along with 885 21-Teal (5/8 yd), 885 222-Hydrangea (1 FQ), 885 238-Topaz (1 FQ), 885 239-Persia (1 FQ), 885 286-Sugarplum (1 FQ), 839 85-Blackberry (1 1/4 yd\*), and 1895 77-Sage (3/8 yd)

\*includes binding

Free pattern available at [www.hoffmanfabrics.com](http://www.hoffmanfabrics.com)



8210. S Holly St. Centennial, CO 80122  
1-888-768-5922 720-529-9659 Fax: 720-529-9639  
[info@mountainpeakcreations.com](mailto:info@mountainpeakcreations.com)

Please view our complete line of patterns at [www.mountainpeakcreations.com](http://www.mountainpeakcreations.com)

BEGINNER |



HOFFMAN FABRICS  
EST.1924



Bear Finished Quilt: 52" x 55"

## Yardage Chart

<b>BEAR</b>	
P4356 44-Forest	1 Panel
885 21-Teal	5/8 yard
885 222-Hydrangea	1 Fat Quarter
885 238-Topaz	1 Fat Quarter
885 239-Persia	1 Fat Quarter
885 286-Sugarplum	1 Fat Quarter
839 85-Blackberry	1 1/4 yard*
1895 77-Sage	3/8 yard

\*includes binding



1895 77-Sage



839 85-Blackberry



885 286-Sugarplum



885 239-Persia



P4356 44-Forest



885 21-Teal



885 222-Hydrangea



885 238-Topaz

Quilt design by Kari Nichols of Mountainpeek Creations, featuring the Call of the Wild digital fabric along with Bali Batiks and Watercolors. Create a true work of art that will be the focal point of any room. Warm and woody.

View swatches and download quilt patterns at [hoffmanfabrics.com](http://hoffmanfabrics.com)

# Bears and Paws

Please Read and Follow Instructions Carefully to Ensure a Successful Project!

## Cutting Instructions:

- A. Panel or Theme Fabric (P4356-44)\*:  
Centering Design, cut 26 1/2" x 41 1/2"
- B. Panel Frame (885-21):  
Cut (4) 4" x WOF\* strips  
Subcut (2) 4" x 41 1/2" strips  
Set aside remainder for side strips
- C. Bear Paw Light Background (1895-77):  
Cut (1) 4 1/2" x WOF strips  
Subcut (4) 4 1/2" x 4 1/2" Squares  
Cut (1) 5" x WOF strip  
Subcut (8) 5" x 5" squares
- D. Bear Paws Dark (4 Fat Quarters 885-286, 885-239, 885-238, 885-222):  
Cut (1) 5" x WOFQ\*\* strip from each fabric  
Subcut (2) 5" x 5" squares from each strip. Total (8) 5" x 5" squares  
Cut (1) 8 1/2" x 8 1/2" square from each of your (4) Fat Quarters
- E. Outer Border (839-85):  
Cut (6) 4" WOF strips
- F. Binding (839-85):  
Cut (6) 2 1/2" x WOF

## *\*Did you know?*

For this pattern, if you have a panel or theme fabric that doesn't have a 26 1/2" vertical measurement, you can adjust the vertical cut on your fabric anywhere from 22 1/2" to 26 1/2". This will not change the overall pattern design

**\*WOF = Width of Fabric From Selvage to Selvage.**

**\*\*WOFQ = Width of Fat Quarter From Selvage to Raw Edge.**

**Note:** All measurements are based on a 1/4" seam allowance unless otherwise noted.

## Piecing Instructions:

### Panel Border:

Using (2) (B) 4" x 41 1/2" Panel Frame strips, join to Top and Bottom of Panel Fabric. See Diagram 1. Press seams toward Frame Strips. To determine the length of your side Panel Frames, measure quilt through the middle from top to bottom. Using remaining (B) 4" x WOF strips, cut to equal this measurement. Join to sides. Press seams toward Panel Frames.

Diagram 1

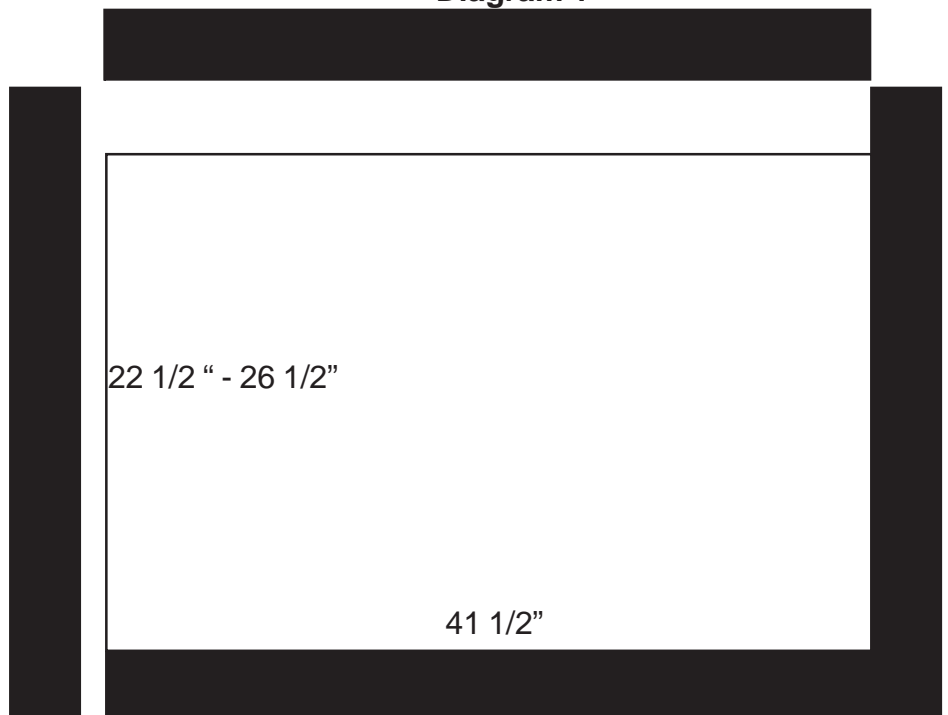

**Piecing Continued:**

**Bear Paw Blocks:**

**Half Square Triangles:**

Following Diagram 2, below, choose one (D) Bear Paw Dark 5" square fabric and one (C) Bear Paw Background Light 5" square fabric. Place the (D) Bear Paw Dark 5" square right sides together with a (C) Background Light 5" square. Draw a line diagonally from corner to corner. Stitch 1/4" on both sides of diagonal line. Cut squares on diagonal line to create two half square triangle blocks. Press seams toward Darker fabric. Square down blocks (center diagonal stitching line with diagonal line on ruler running corner to corner and trim) to 4 1/2". Repeat using remaining (D) Bear Paw Dark and (C) Background Light 5" squares. You will have (16) half square triangle blocks from the Dark and Light Bear Paw fabrics.

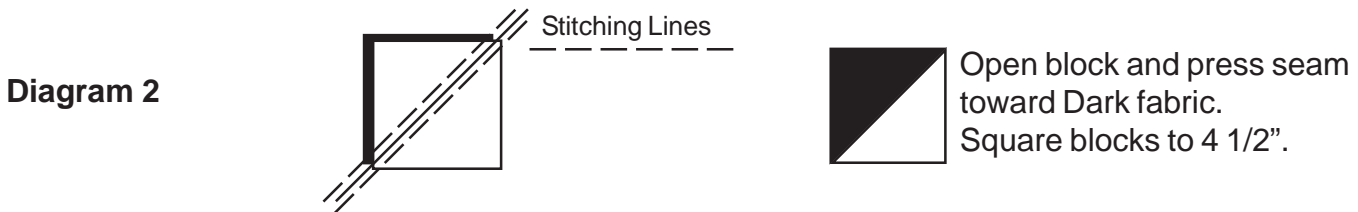

You will have (16) Half Square Triangles, (4) for each Bear Paw block. Place same Half Square Triangle block fabric with matching 8 1/2" square Bear Paw fabric for each of (4) blocks.

**Paw Block:**

Choosing a (D) Bear Paw Dark 8 1/2" x 8 1/2" Square, (4) Half Square Triangle blocks of the same Bear Paw Dark fabric and a (B) 4 1/2" x 4 1/2" Background Light square, follow Diagram 3, below, to complete Paw Block. Make (4) Paw Blocks using same Bear Paw Dark fabric in each block. Repeat with remaining 3 color sets for a total of (4) Blocks.

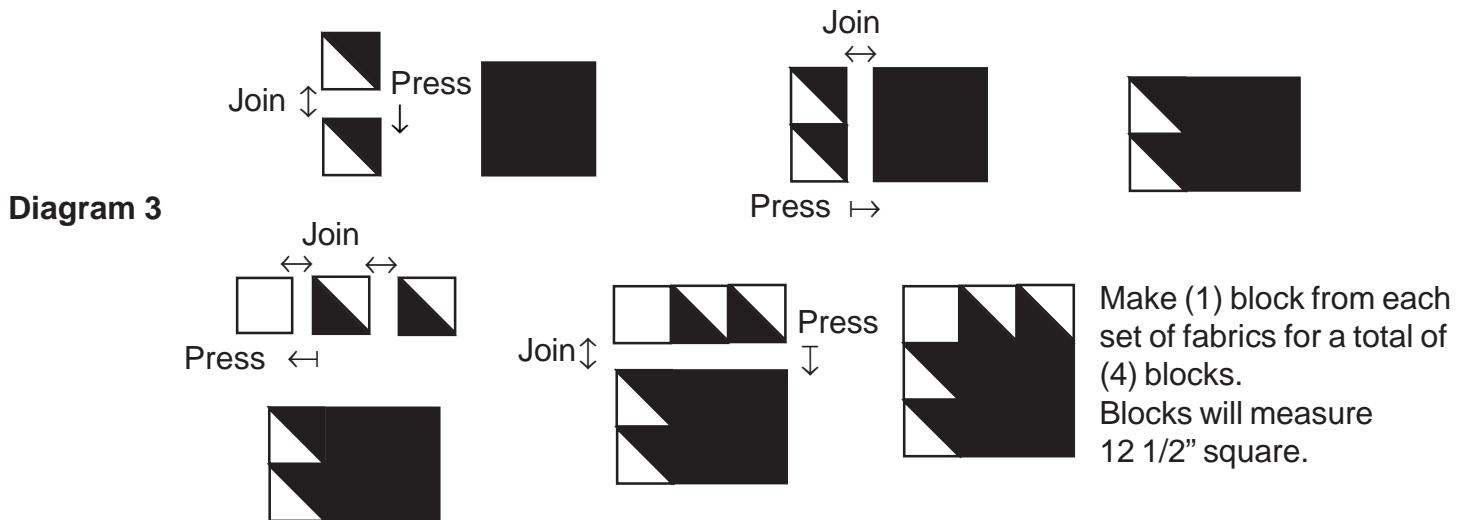

Join blocks into a row. Row will measure 12 1/2" x 48 1/2".

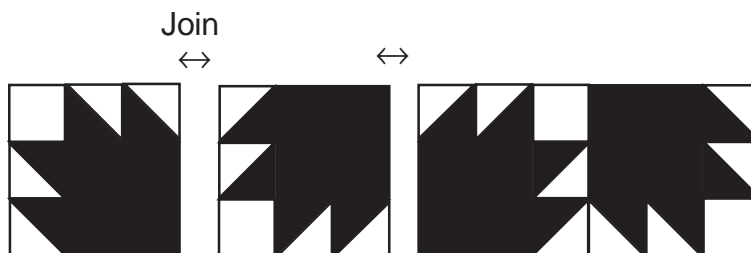

## **Layout:**

Join row of Paw Blocks to bottom of Bear Panel.



Join ⇅

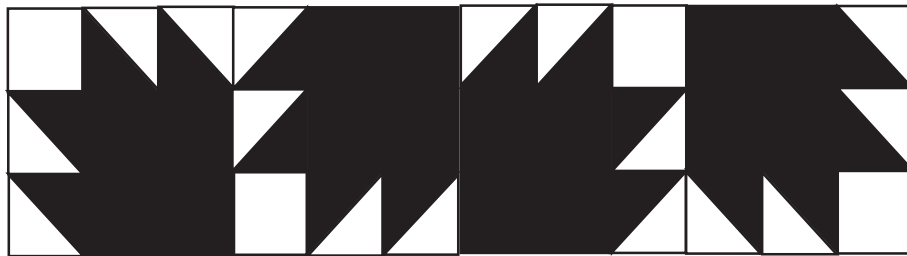

## **Borders:**

To determine the length of the outer side borders, measure quilt through the middle from top to bottom. Using (E) 4" Outer Border strips, cut to equal this measurement. Make (2). Attach border strips to sides of quilt. Press seams toward outer border. Next, measure quilt through the middle from side to side to determine the length of the top and bottom outer borders. Using remaining (E) 4" Outer Border strips, join to equal this measurement. Make (2). Attach to the top and bottom of quilt and press seams toward inner border. Your quilt top should measure 55 1/2" x 52 1/2" (if using a 26 1/2" x 41 1/2" center panel). See full layout diagram on Pg. 4.

## **Quilting:**

Sandwich quilt top with batting and backing. Baste layers together and quilt as desired to enhance design.

## **Binding:**

Join together (F) 2 1/2" Binding strips and bind using your favorite method.

## Layout Diagram

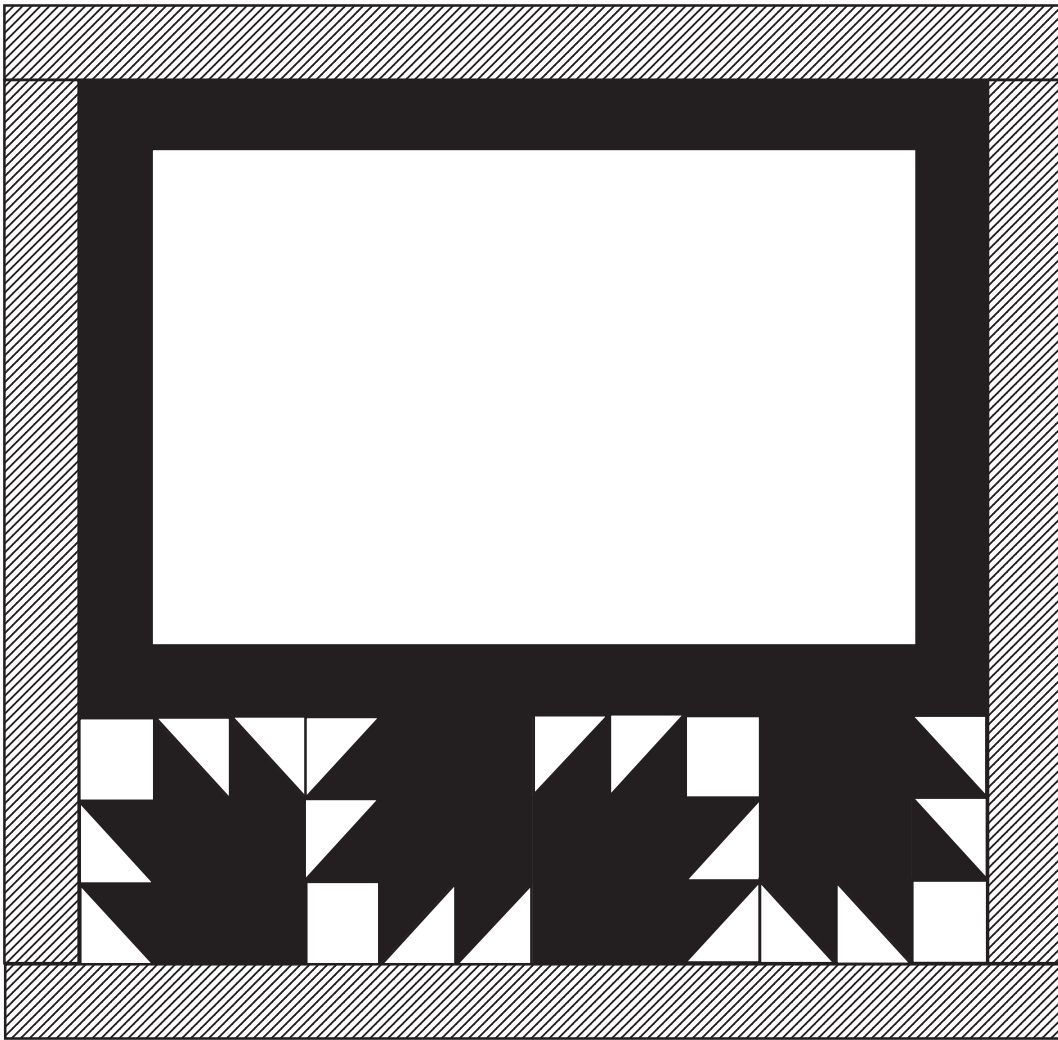

**Enjoy Your Beautiful Creation!**

© Mountainpeek Creations™ 2017 - This pattern is copyrighted. We have produced it for you personally. It is against the law to reproduce any part of this pattern for other than your personal use. Thank you for your consideration.